

R10 (ETL)

2- Speed, 208-240 Volt, 3 Phase, 60Hz.,
 Low Speed- 1725 RPM, 9 Amp, 3 HP.
 High Speed- 3450 RPM, 12.5 Amp, 4.5 HP.

Machines with serial numbers R10-000376 and above.

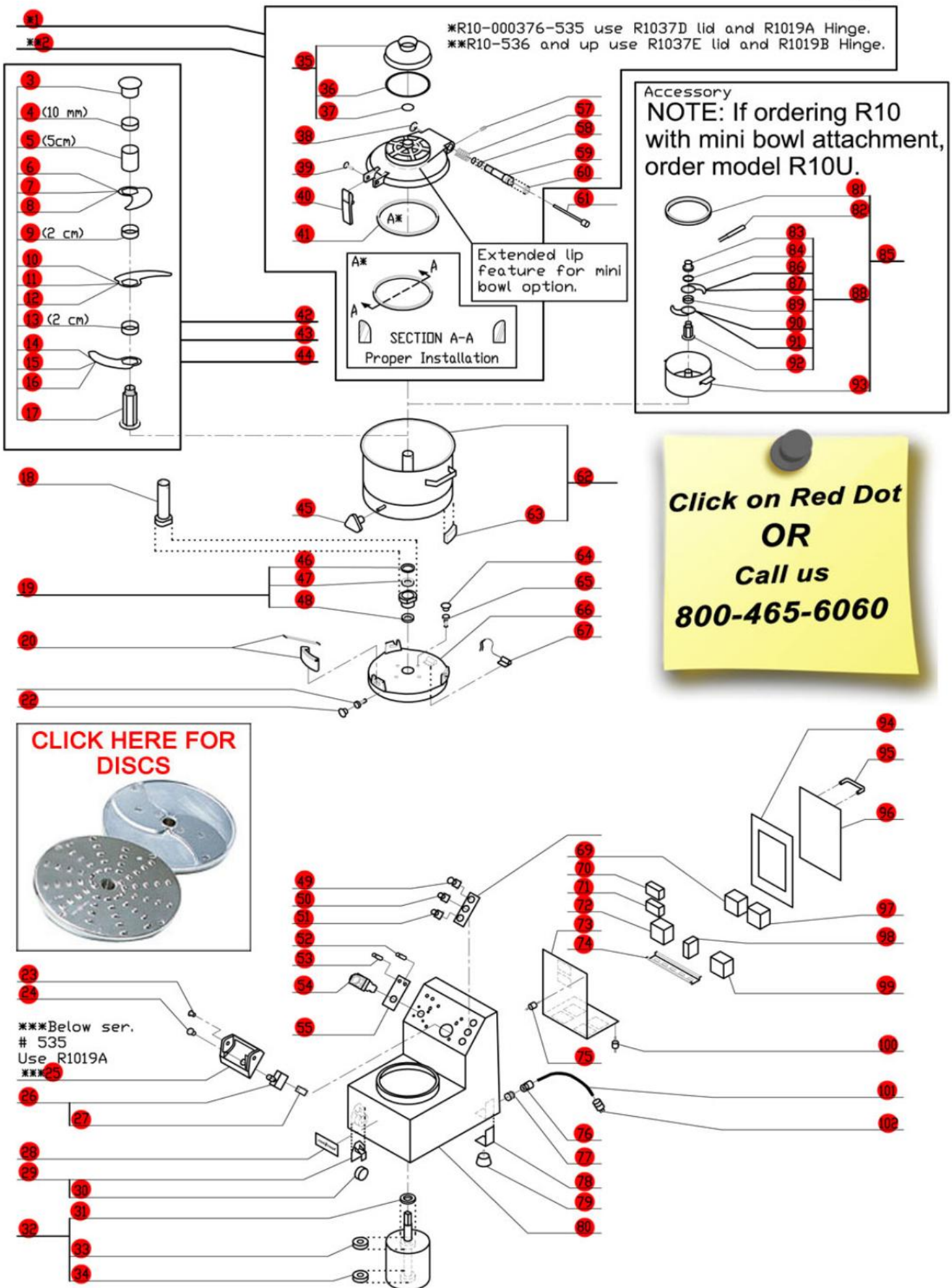

*R10-000376-535 use R1037D lid and R1019A Hinge.
 **R10-536 and up use R1037E lid and R1019B Hinge.

Accessory

NOTE: If ordering R10 with mini bowl attachment, order model R10U.

**Click on Red Dot
 OR
 Call us
 800-465-6060**

CLICK HERE FOR DISCS

***Below ser. # 535 Use R1019A
 ***25